

Soundac® ElastiRail

Vibration insulation wooden rail to construct floating ceilings and flexible double walls

Soundac® ElastiRail is developed to reduce vibrations and is therefore very well suited for floating ceilings and flexible double walls.

ElastiRail disconnects the existing floor or wall and with this the airborne noise (speech) and impact sound (footsteps) is reduced. The weight of the floating ceiling determines the number of insulators.

Description

Soundac® ElastiRail is constructed of a wooden rail with the vibration insulating Sylo-elast®. The rail has pre drilled holes for an easy assembly. The Sylo-elast® fits in the holes.

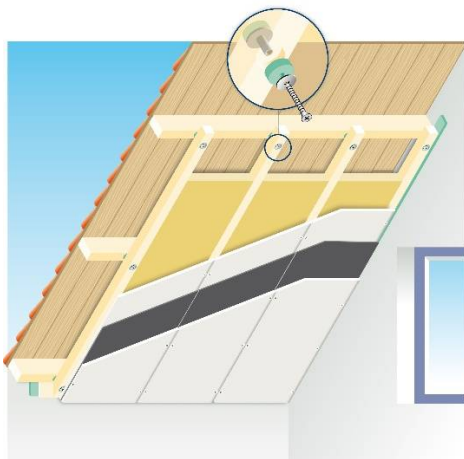

Properties

- Floating ceilings and walls
- Well suited for pitched roofs
- Various weights possible
- Easy assembly

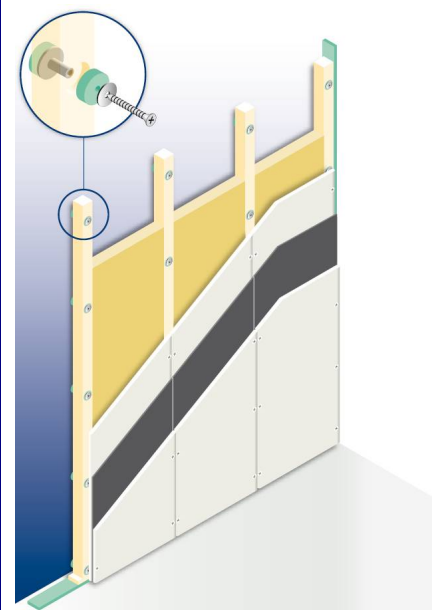



Converting

Soundac® ElastiRail is screwed to the existing subsoil with an distance of approx. 400 mm. It is important that the top and bottom of the rail (and the platers board) are free from the floor and ceiling.

To ensure the disconnection of the Soundac® ElastiRail and surrounding surfaces Sylo-elast® strips can be applied.

Characteristics

- Length 2,700 mm
- Width 70 mm
- Thickness 45 mm
- Vibration insulation Sylo-elast®

Despite the careful composition of this datasheet no rights can be derived from this. Changes are reserved.